

DELCO-MORAINE DUAL DIAPHRAGM

Chevrolet
GMC
Jeep

DESCRIPTION

Unit is mounted on firewall and connected directly to brake pedal. A combination of vacuum and atmospheric pressure is used to provide power assist. Power cylinder houses power piston assembly which contains primary and secondary diaphragms, pistons, floating control valve, reaction piston, and disc.

REMOVAL & INSTALLATION

CHEVROLET & GMC

Removal & Installation — Remove 2 nuts securing master cylinder to power cylinder, and move master cylinder away from power cylinder. Do not disconnect hydraulic lines. Disconnect vacuum hose from vacuum check valve. Disconnect power brake push rod from brake pedal. Remove 4 nuts securing power brake to firewall. To install, reverse removal procedures.

JEEP

Removal & Installation — 1) Disconnect power brake unit push rod at brake pedal. Discard attaching bolt and nut. Disconnect vacuum hose at unit check valve.

2) Remove nuts and washers securing master cylinder to unit. Move master cylinder to one side. Do not disconnect brake lines at master cylinder.

3) Remove nuts securing power unit to firewall and remove power unit. To install, reverse removal procedures. Use a new replacement bolt to secure rod to pedal.

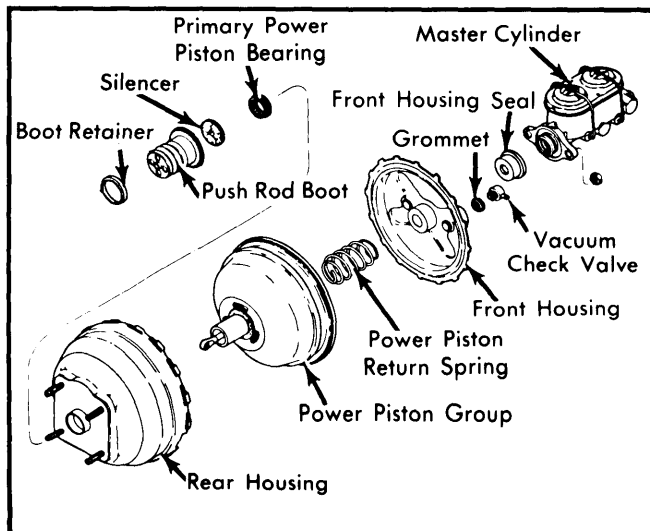

Fig. 1 Exploded View of Delco-Moraine Dual Diaphragm Power Brake Unit.

OVERHAUL

NOTE — Jeep Corp. does not recommend overhaul of this unit; it is serviced as an assembly.

Disassembly — 1) Scribe a line across front and rear housing for reassembly. Remove vacuum valve and grommet from front housing and discard.

2) Position housing unlock tool (J-23456) in a vise. Mount diaphragm unit in tool so that 4 studs on unit fit in holes provided in tool. Straighten staked interlocks.

3) Position spanner wrench over two studs with tubular portion of wrench that fits over the studs down. Rotate screw on unlock tool to apply downward pressure to housing. Turn handle counterclockwise to unlock housing. Turn screw to release tension and remove front housing.

4) Remove tools from housings. Remove power piston return spring. Remove boot and boot retainer from the rear housing and push rod. Remove felt silencer from inside the boot. Remove power piston assembly. Remove power piston bearing from center opening in rear housing.

5) Remove reaction retainer and piston rod from power piston. Remove silencer from neck of piston tube. Turn power piston upside down so end of push rod is against a hard surface. Use a slight force or impact on push rod to remove diaphragm retainer.

6) Remove diaphragms, support plates and divider from power piston. Remove center bearing from housing divider. Separate primary and secondary diaphragms from support plate.

7) Remove reaction body retainer using a screwdriver. Remove reaction body. Using a small dowel, push down on the end of reaction piston and remove reaction disc and piston from reaction body.

8) Remove air valve spring. Remove rubber reaction bumper from end of air valve. Remove retaining ring from air valve. Remove air filter from tube portion of power piston.

NOTE — If air valve push rod has a formed eye on the end, it cannot be serviced and must be replaced as an assembly.

9) Remove air valve push rod assembly from push rod end of power piston by pressing out using an arbor press. Use a mandrel no larger than 1/2" diameter.

NOTE — The push rod can be removed by inserting a heavy shanked screwdriver on both sides of push rod and pulling straight out. A considerable amount of force will be required.

10) With air valve push rod removed, control valve retainer can be removed. Remove "O" ring from air valve.

Cleaning & Inspection — Clean all plastic, metal and rubber parts in denatured alcohol. Blow out all passages, orifices and valve holes. Air dry all parts. Slight rust on housing may be cleaned with crocus or emery cloth. Clean parts with alcohol after using crocus or emery cloth. Replace all rubber parts with cuts, nicks or distortion. If in doubt, replace the parts.

DELCO-MORAINÉ DUAL DIAPHRAGM (Cont.)

Reassembly — 1) Install new check valve grommet, check valve and seal in front housing. Lubricate air valve "O" ring with power brake lubricant and install on air valve.

2) Apply power brake lubricant to outside of floating control valve.

NOTE — If floating control valve needs replacement, replace complete air valve push rod assembly.

3) Position air valve end of push rod in power piston. Press down on push rod so that floating control valve bottoms on tube section of power valve.

4) Place retainer lip on the outside of retainer installation tool (J-23175). Press retainer in until seated in power tube piston. Install filter element over push rod eye and press into power piston tube.

5) Install snap ring in groove in air valve. Install rubber reaction bumper on end of air valve. Install air valve spring on end of air valve.

6) Install reaction body with large hole up. Install reaction body retainer. Install reaction piston into reaction body with large diameter up.

7) Apply power brake lubricant to the outside of the rubber reaction disc. Place disc in cavity in reaction body.

8) Place power piston on bench with push rod up. Install assembly cone (J-28458) over push rod end of piston.

9) Install secondary diaphragm on secondary support plate. Press raised flange on the diaphragm through the center hole on support plate. Make sure edge of support plate fits into groove in diaphragm flange.

10) Apply power brake lubricant to the inside diameter of the secondary diaphragm. With assembly cone on power piston place secondary diaphragm and support plate on power piston and push down until it bottoms on power piston.

11) Hold housing divider so that flange that holds primary diaphragm faces down. Place power piston bearing in the inside of divider so that extended lip of the bearing faces up.

12) Apply power brake lubricant to inside diameter of power piston bearing. With assembly cone on power piston, hold housing divider so that flange that holds primary diaphragm faces up.

13) Press divider down over tool and onto power piston tube until it rests against secondary diaphragm.

14) Install primary diaphragm on primary support plate. Press raised flange on diaphragm through center hole of support plate. Make sure edge of support plate fits in groove in diaphragm flange. Apply power brake lubricant to inside diameter of diaphragm.

15) Remove assembly cone from power piston. Fold primary diaphragm away from outside of primary support plate. Place primary diaphragm assembly over power piston. Push down until it bottoms.

16) Fold primary diaphragm back into position on support plate. Pull outside diameter of diaphragm over flange of housing divider. Make sure bead on diaphragm is seated evenly around entire area.

17) Position diaphragm retainer over power piston and onto diaphragm. Place assembly cone (J-28458) over power piston onto diaphragm retainer. Strike with hammer until retainer is locked on neck of power piston.

18) Install power head silencer over neck of power piston until it rests on retainer. Apply a thin film of power brake lubricant to outside of piston rod retainer. Insert master cylinder piston rod retainer into cavity in power piston so that flat end bottoms against rubber reaction disc in bottom of cavity.

19) Install power piston bearing in rear housing center hole so that flange of center hole in housing fits into groove of power piston bearing. Thin lip of bearing will protrude to outside of housing. Apply power brake lubricant to the inside of power piston bearing.

20) Position housing unlock tool (J-23456) in a vise. Mount rear housing in tool and retain with two nuts. Install power piston assembly in rear housing by pressing tube through rear housing bearing.

21) Press down until housing divider seats in rear housing and power piston bottoms against housing. Install power piston return spring over reaction body retainer.

22) Position front housing over rear housing aligning scribe marks made during disassembly. Install spanner wrench on front housing.

23) Tighten down on front housing and fit tangs in correct slots in rear housing. Rotate spanner wrench clockwise until front and rear housings lock.

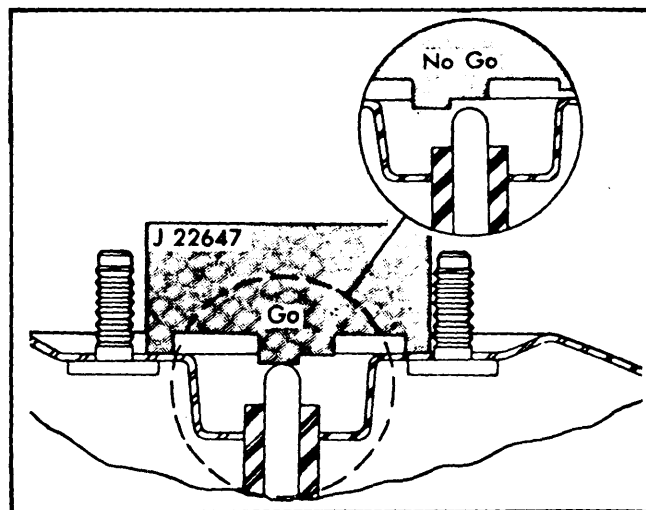

Fig. 2 Gauging Push Rod Position

Power Brake Units

DELCO-MORAINE DUAL DIAPHRAGM (Cont.)

24) Remove spanner wrench from front housing. Stake housing interlocks at 2 new positions, 180° apart.

ADJUSTMENT

PUSH ROD ADJUSTMENT

NOTE — This adjustment applies to Chevrolet and GMC only. Jeep push rod is non adjustable.

1) Insert master cylinder piston rod, flat end first, into piston rod retainer. Ensure rod is properly seated. Remove front housing seal to assure there is no vacuum in unit.

2) Place suitable gauge (J-22647) over piston rod, in a position which will allow gauge to be moved right or left without contacting studs. Piston rod should contact longer section of gauge. Rod is non-adjustable; if out of limits, replace with proper service rod.

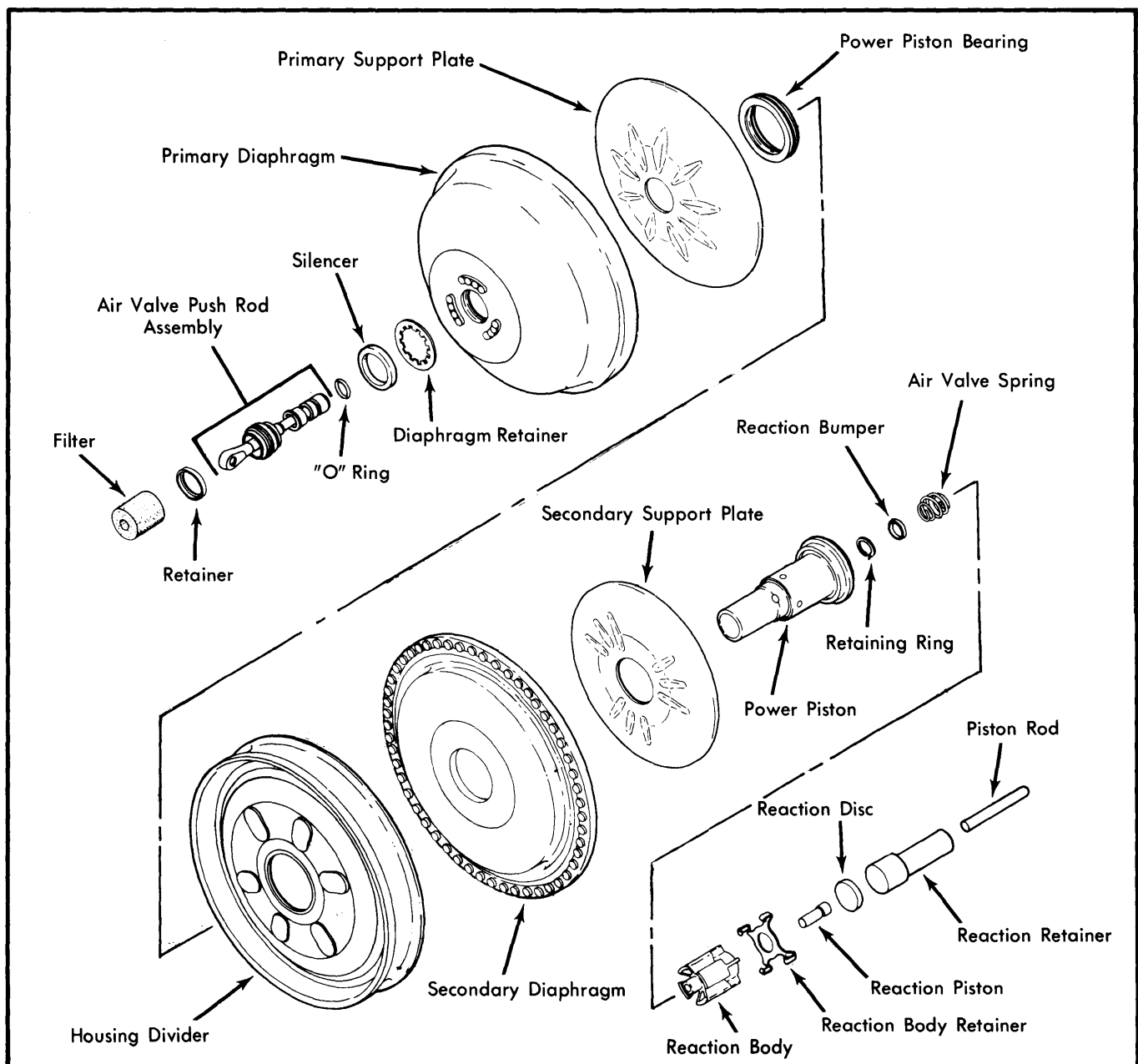

Fig. 3 Exploded View of Power Piston Assembly