

CADILLAC

CAPACITY (in quarts)		
APPLICATION	STANDARD	OPTIONAL
1965 All Exc. 75 Series 75 Series	19 19.8	19 20.8
1966 All Exc. 75 Series 75 Series	18	19 20.5
1967 All Exc. 75 Series 75 Series	17	18.5 20.5
1968 All Exc. 75 Series 75 Series	20.3	20.8 23.8
1969-73 All Exc. 75 Series ① 75 Series ①②	21.3	21.8 24.8

① - On 1972 models, add 2 qts. with heavy duty cooling.

② - 1973 models 26.8 qts.

FILL LEVEL

1965-66- Fill radiator to "Fill Cold" mark when cool.

1967-68 - Fill to 1" (Hot), or 3" (Cold) below bottom of filler neck.

1969-73- All models use a coolant recovery system. Do NOT remove radiator cap to check coolant level. Keep coolant level between "Full" and "Add" marks on coolant overflow bottle.

THERMOSTAT

Thermostat application and testing are as follows:

Application	① Initial Open	① Fully Open
1965	172-177	197
1966	177-182	202
1967 (Without A/C)	192-197	217
(With A/C)	177-182	202
1968-69	192-197	217
1970-73	177-182	202

① - All temperatures are in °F.

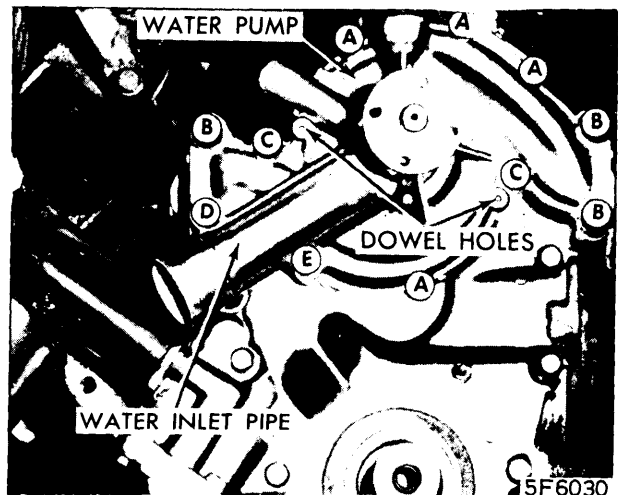

Key	(No.)	Size	Torque
A	(4)	1/4-20 x 1-1/4	5 Foot Pounds
B	(3)	3/8-16 x 3-5/8	20 Foot Pounds
C	(2)	5/16-18 x 3-1/4	10 Foot Pounds
D	(1)	3/8-16 x 5	20 Foot Pounds
E	(1)	1/4-20 x 2-1/4	5 Foot Pounds

PRESSURE VALVE

All models use a 15 lb. radiator cap. Test at 13.5-16.5 lbs.

WATER PUMP ATTACHING BOLT LOCATIONS
& TORQUE SPECIFICATIONS - 1965-67

CADILLAC (Cont.)

WATER PUMP

NOTE – Some water pumps may have a reddish or greenish coolant stain at vent hole below shaft. This is a normal condition and water pump should not be serviced unless it is obviously leaking with the engine running.

Water pump is mounted on front engine cover. All 1965-70 model pumps are serviced by replacement only, pump cannot be overhauled. On 1971-73 models overhaul of pump is possible only if special tool kit is used. Tool kit and overhaul parts kits are available.

Removal – Disconnect battery and drain radiator. Remove fan shroud and fan assembly. Remove all belts and water pump pulley. Disconnect water inlet from pump, remove pump.

Installation – Reverse removal procedure and observe the different screw sizes and torque specifications as shown in illustration.

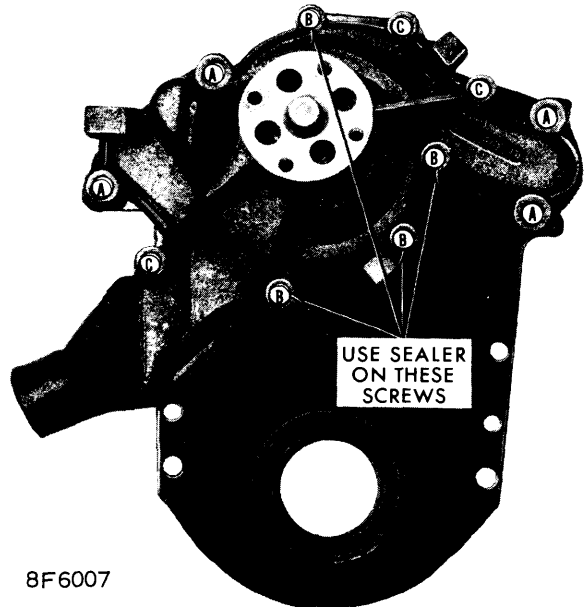

8F6007

Key	No.	Size	Torque
A	(4)	3/8 - 16 x 1-3/8	22 foot-pounds
B	(4)	1/4 - 20 x 1-1/8	70 inch-pounds
C	(3)	5/16 - 18 x 1-1/4	15 foot-pounds

WATER PUMP ATTACHING BOLT LOCATIONS & TORQUE SPECIFICATIONS – 1968-73

MAINTENANCE

Inspect, drain, clean and flush cooling system every 24 months.

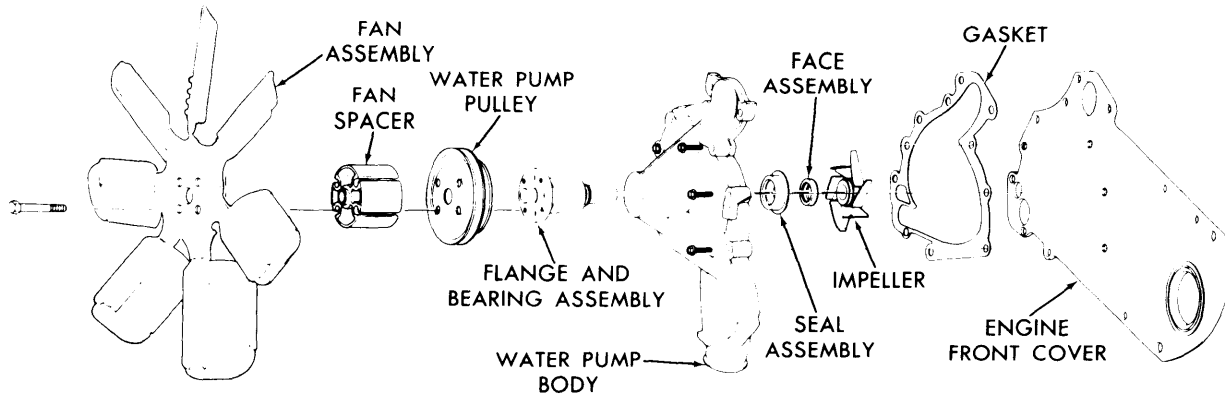

3V116

1968-73 WATER PUMP DISASSEMBLED